

COASTAL HYDRAULIC CRANES, INC.

HOUSTON, TEXAS

CRANE MODEL CTA 5-3-50

STATIC RATED LOAD IN LBS.				
		FULLY RETRACTED	TIP RETRACTED	FULLY EXTENDED
REACH IN FEET	5	11,500	10,000	10,000
	10	9,800	8,300	8,100
	15	7,000	5,900	5,700
	20	4,100	4,500	4,400
	25	~	3,500	3,500
	30	~	2,800	3,000
	35	~	1,800	2,500
	40	~	~	2,200
	45	~	~	1,800
	50	~	~	900

NOTE: THE ABOVE RATED LOADS DO NOT INCLUDE WEIGHTS OF HOOKS, BALL ETC. TO OBTAIN SWL THESE WEIGHTS HAVE TO BE DEDUCTED FROM THE ABOVE VALUES.

MAXIMUM OVERTURNING MOMENT: 223,720 FT-LBS.

MAXIMUM VERTICAL REACTION: 40,620 LBS.

TOTAL WEIGHT: 8,000 LBS. APPROX.

WINCH CAPACITY: 7,500 LBS. (BARE DRUM)

WIRE ROPE CAPACITY: 5,320 LBS.

ALL LIFTS ABOVE 5,320 LBS. REQUIRE 2 OR 3 PARTS OF LINE.

!! WARNING !! DO NOT LOAD BEYOND ITS RATED CAPACITY !!

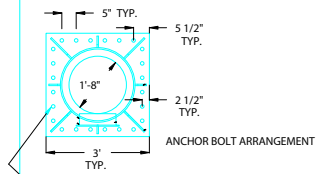
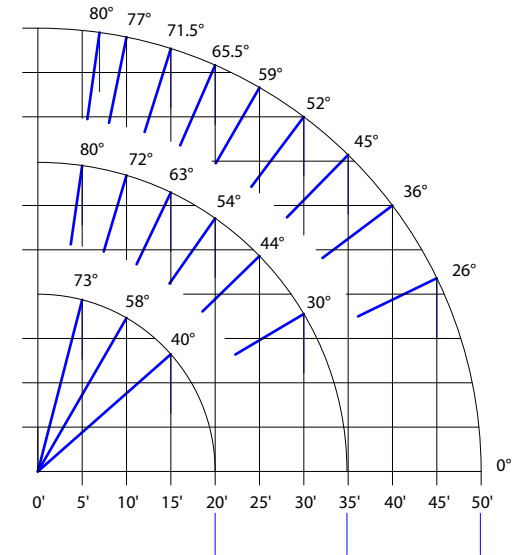

1 1/8" Ø HOLES (24) FOR 1" ANCHOR BOLTS

ESKRIDGE E36 SWING BOX
W/ 90B SERIES ROTATION BRAKE
CHARLYNN OR WHITE HYDRAULIC SWING MOTOR

